

**7 TON BITUMINOUS PATCH (<1000 ADT)
SANDY SOILS (AASHTO SOILS A-1, A-2)**

NOT TO SCALE
PLATE 1002

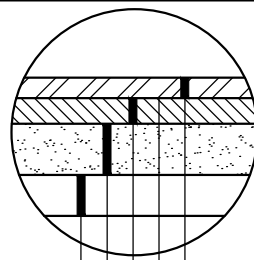

**7 TON BITUMINOUS PATCH (<1000 ADT)
CLAY SOILS (AASHTO SOILS A-6, A-7)**

NOT TO SCALE
PLATE 1002

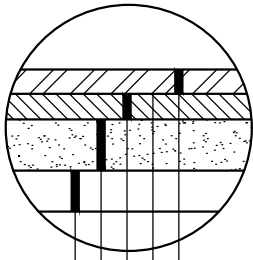

**9 TON BITUMINOUS PATCH (<300 HCADT)
SANDY SOILS (AASHTO SOILS A-1, A-2)**

NOT TO SCALE
PLATE 1002

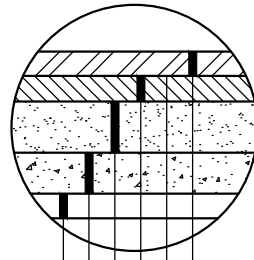

**9 TON BITUMINOUS PATCH (<300 HCADT)
CLAY SOILS (AASHTO SOILS A-6, A-7)**

NOT TO SCALE
PLATE 1002

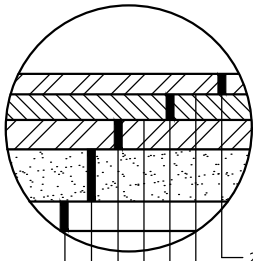

**10 TON BITUMINOUS PATCH (>1100 HCADT)
SANDY SOILS (AASHTO SOILS A-1, A-2)**

NOT TO SCALE
PLATE 1002

BITUMINOUS TYPICAL SECTION

STANDARD DETAIL
PLATE NO:
1002

APPROVED: ADOPTED BY CITY COUNCIL ON JANUARY 12, 2004

REVISED: REVISION ADOPTED BY CITY COUNCIL ON APRIL 09, 2018

REMARKS:

SAINT PETER UTILITY STANDARD DETAIL



CITY OF
Saint Peter
NICOLET COUNTY, MINNESOTA
WHERE HISTORY & PROGRESS MEET